

ANSWERS

1	2	1
2	WILLIAM / "ON THE DOT ARCHITECTS"	1
3	1 : 800	1
4	VERNON	1
5	NAT PRINTERS	1
6	0 / NONE / NOT APPLICABLE	1
7	2015-05-06	1
8	2 / 3	1
9	INSPECTION CHAMBER	1
10	BLACK	1
11	CONTOUR LINE	1
12	MILLIMETRE / mm / METRIC	1
13	COMPACTED HARD CORE	1
14	ELECTRIC SECURITY FENCE	2
15	GATE OPENING DIRECTION	1
16	SERVITUDE	2
17	STOREROOM OVER BUILDING LINE	2
18	369,14 m [calculations 1, answer 1, metres 1]	3
19	2184 m ² [calculations 2, answer 1, metres ² 1]	4
20		3
TOTAL		30

ANSWER 18

Show ALL calculations.

$$\begin{aligned}
 L &= 2(L + B) \\
 &= (2 \times 74569) + (2 \times 116000) \quad \checkmark_1 \\
 &= 149,138 + 232,000 \\
 &= 381,138
 \end{aligned}$$

$$\begin{aligned}
 &= 381,138 - \text{GATE} \\
 &= 381,138 - 12,000 \\
 &= 369,138 \text{ of } 369,14 \quad \checkmark_1 \quad \checkmark_1
 \end{aligned}$$

ANSWER 19

Show ALL calculations.

$$\begin{aligned}
 B A &= 9[(12,4 \times 20) - (4 \times 4)] + (12 \times 8) \quad \checkmark_1 \quad \checkmark_1 \\
 &= 9(248 - 16) + 96 \\
 &= 2088 + 96 \\
 &= 2184 \text{ m}^2 \quad \checkmark_1 \quad \checkmark_1
 \end{aligned}$$

ANSWER 20 FREEHAND ①

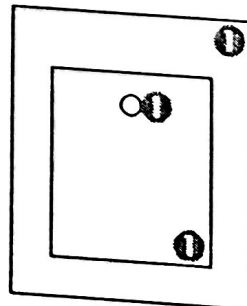
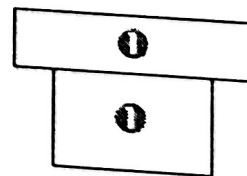

ANTWOORDE		
1	2	1
2	WILLIAM / "ON THE DOT ARGITEKTE"	1
3	1 : 800	1
4	VERNON	1
5	NAT DRUKKERS	1
6	0 / GEEN / NIE VANTOEPASSING	1
7	2015-05-06	1
8	2 / 3	1
9	INSPEKSIEKAMER	1
10	SWART	1
11	KONTOERLYN	1
12	MILLIMETER / mm / METRIES	1
13	VERDIGTE HARDE PUIN	1
14	ELEKTRIESE VEILIGHEIDSHEINING	2
15	HEK-OOPMAAKRIGTING	1
16	SERWITUUT	2
17	STOORKAMER OOR DIE BOULYN	2
18	369,14m [berekening 1, antwoord 1, meter 1]	3
19	2184 m ² [berekening 2, antwoord 1, metres ² 1]	4
20		3
TOTAAL		30

ANTWOORD 18
 Toon ALLE berekeninge.

$L = 2(L + B)$
 $= (2 \times 74569) + (2 \times 116000) \checkmark 1$
 $= 149,138 + 232,000$
 $= 381,138$
 $= 381,138 - \text{HEK}$
 $= 381,138 - 12,000$
 $= 369,138 \text{ or } 369,14 \checkmark 1 \checkmark 1$

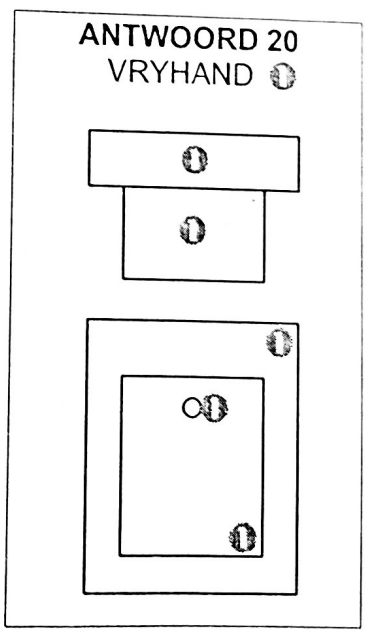

ANTWOORD 19
 Toon ALLE berekeninge

$B A = 9[(12,4 \times 20) - (4 \times 4)] + (12 \times 8) \checkmark 1 \checkmark 1$
 $= 9(248 - 16) + 96$
 $= 2088 + 96$
 $= 2184 \text{ m}^2 \checkmark 1 \checkmark 1$

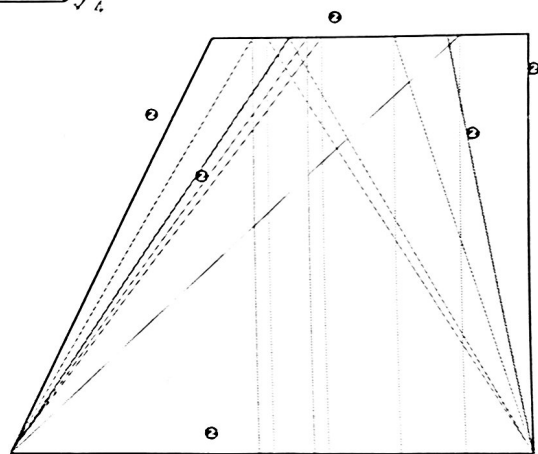
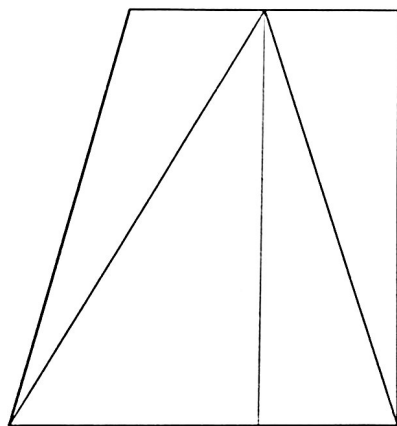
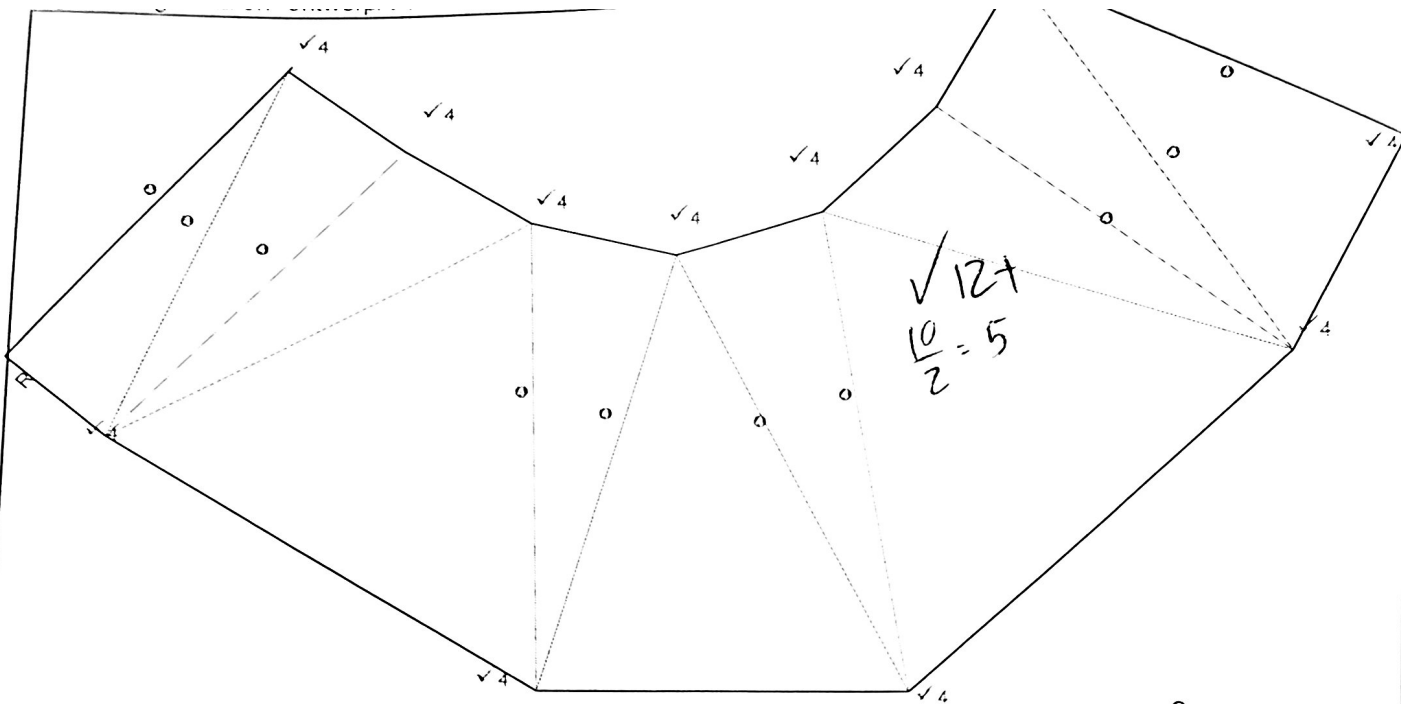

WARE LENGTES
TRUE LENGTHS

$$\sqrt{1 \times 6} = 6$$

X ————— Y

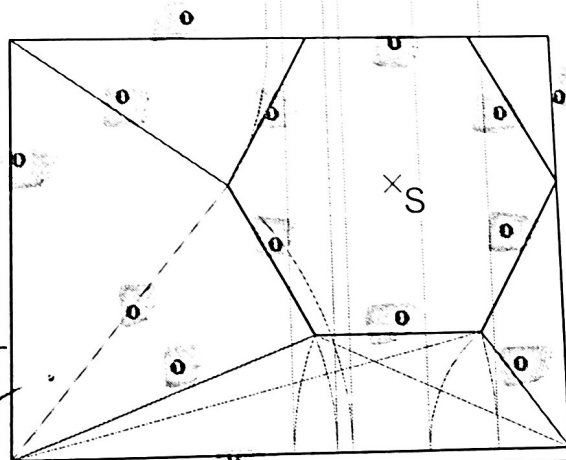

ASSESSMENT CRITERIA			ASSESSERINGSKRITERIA		
1	HEXAGON CONSTRUCTION + TOP VIEW	7	1	SESKANT KONSTRUKSIE + BOAANSIG	7
2	FRONT VIEW	3	2	VOORAANSIG	3
3	TRUE LENGTHS	6	3	WARE LENGTES	6
4	DEVELOPMENT	17	4	ONTWIKKELING	17
TOTAL		33	TOTAAL		33

3

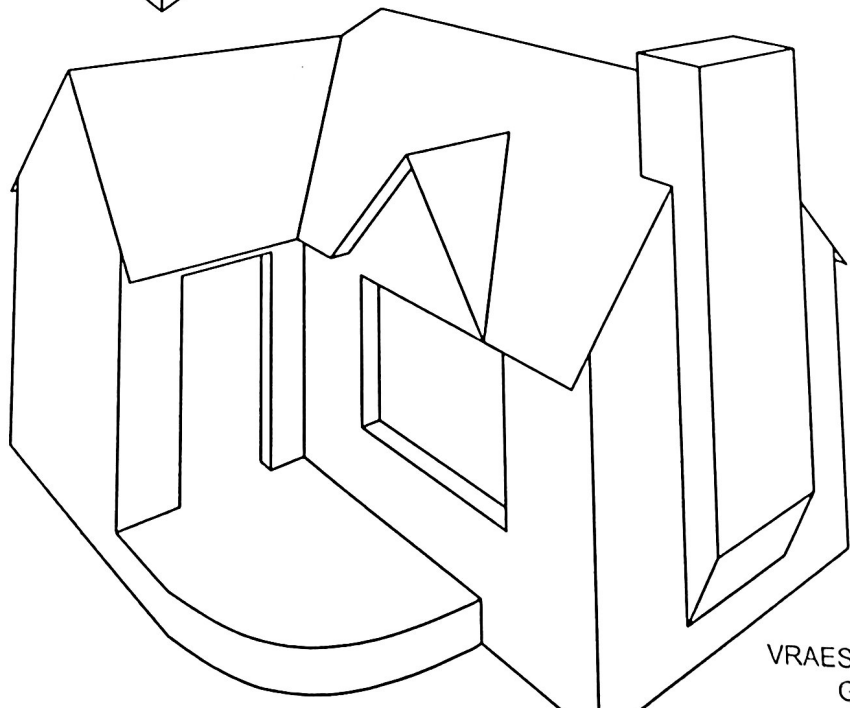
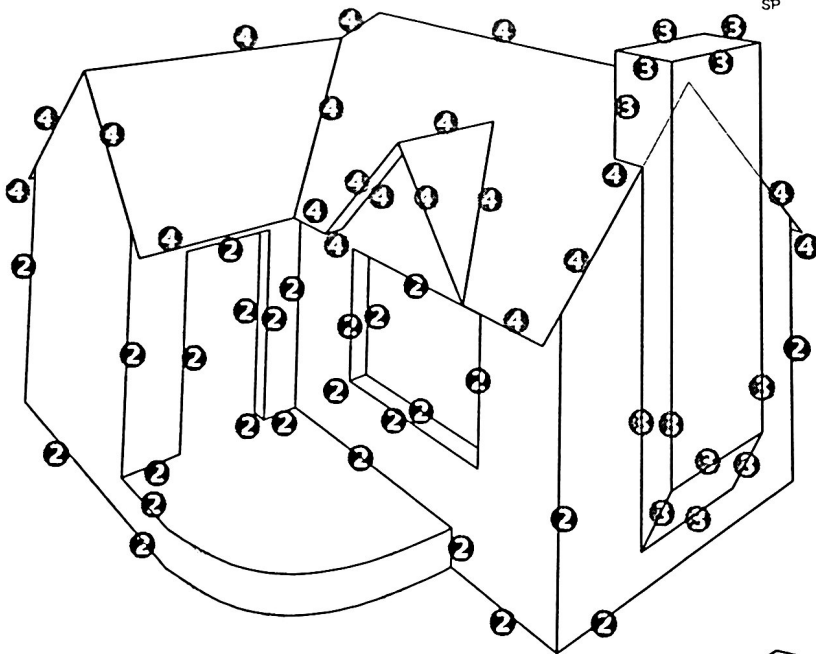
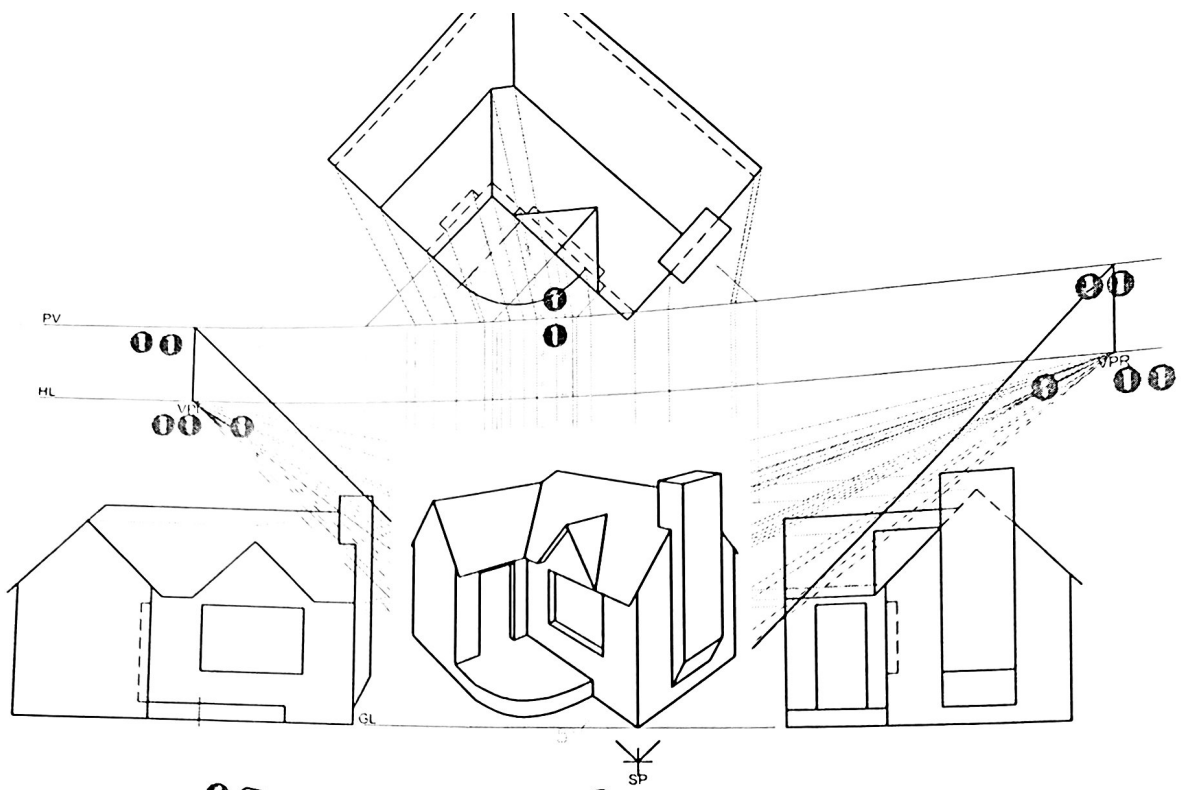

ASSESSERINGSKRITERIA

1	KONSTRUKSIE	6
2	MURE, VENSTER, DEUR	13
3	SKOORSTEEN	6
4	DAK	10
5	BOOG	5
TOTAAL		40

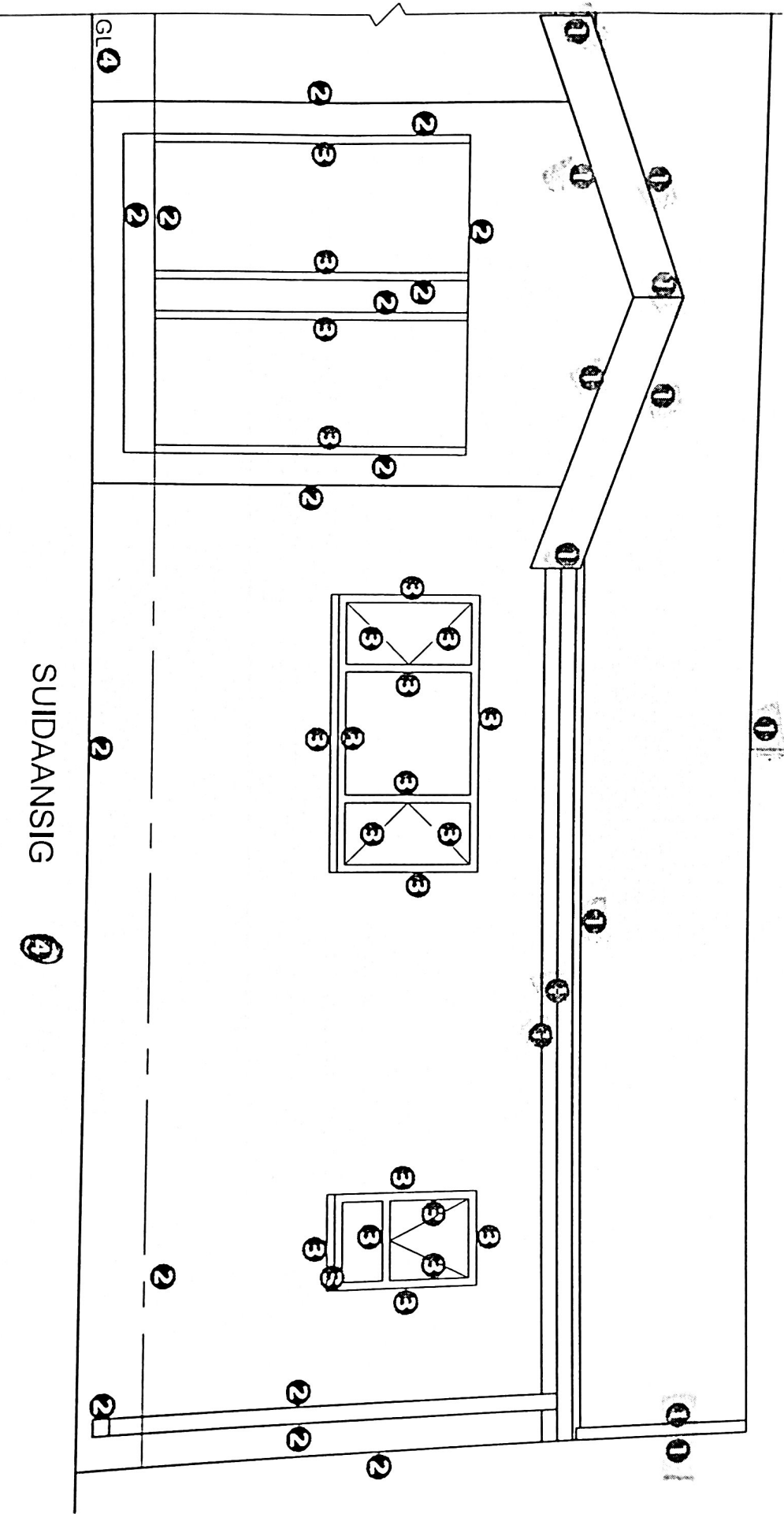

SUDAANSIG

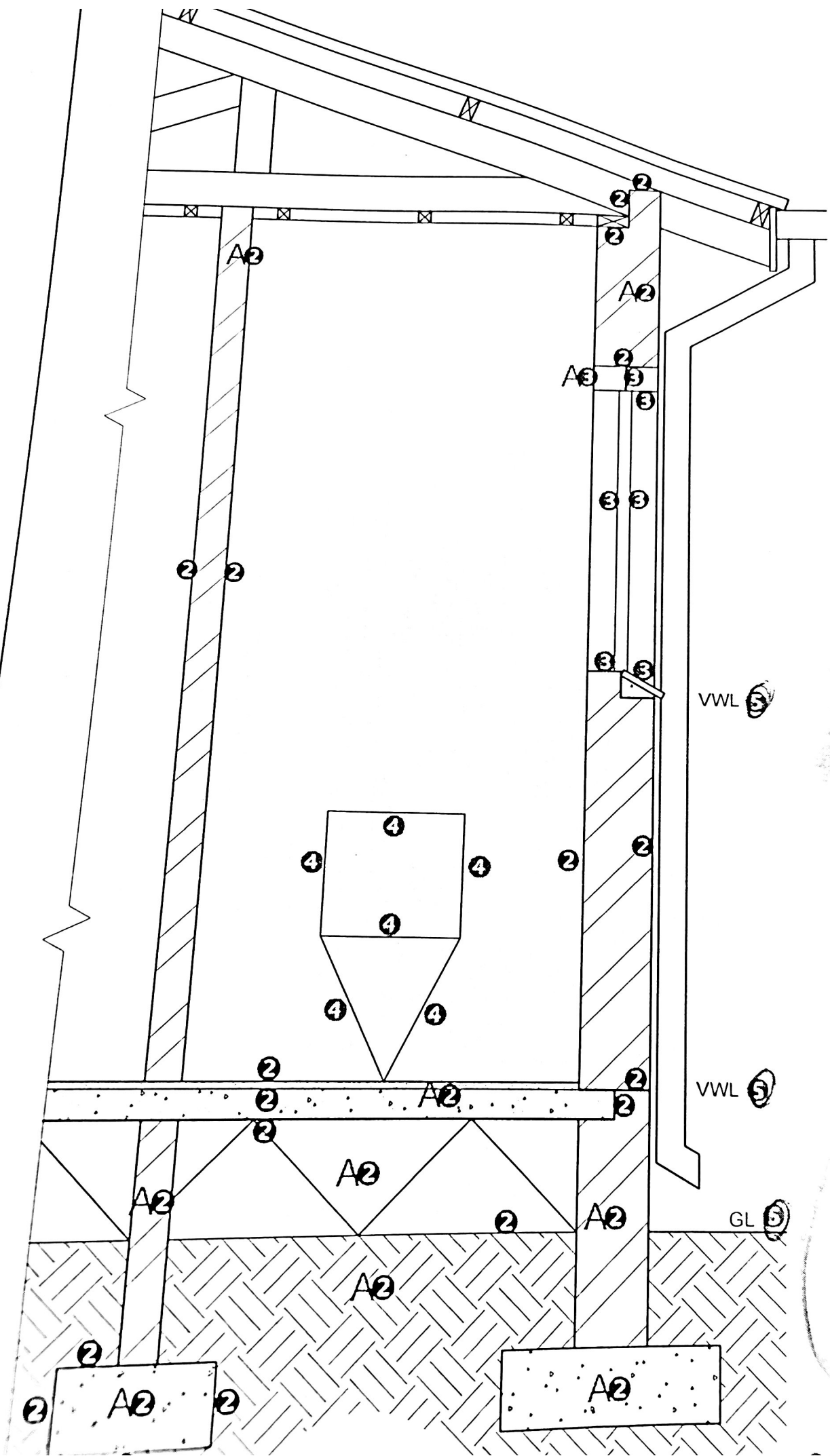

1. PUNTETOEKENN
 VAN DAK
- A. DAKHELLING
 - B. DAKBEDEKING
 - C. DAKLATTE + SP
 - D. DAKKAP
 - E. FASSIEPLANK
 - F. MUURPLAAT
 - G. PLAFONLATTE
 - H. PLAFONBORD
 - I. GEUT + RWAP
- TOTAAL

ASSESE	
GEDETAI	
1	ROOF DET

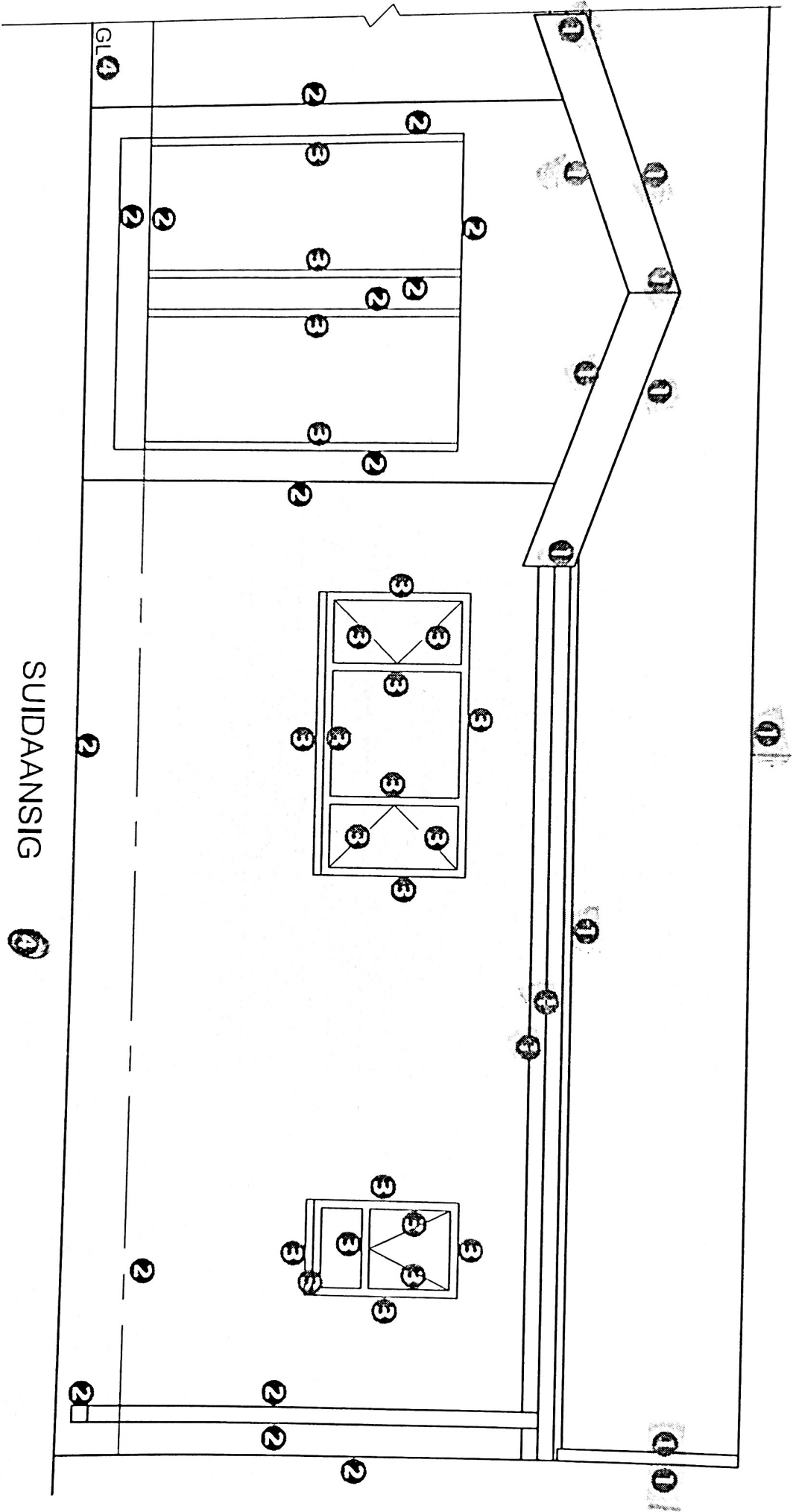

SUIDANSIG



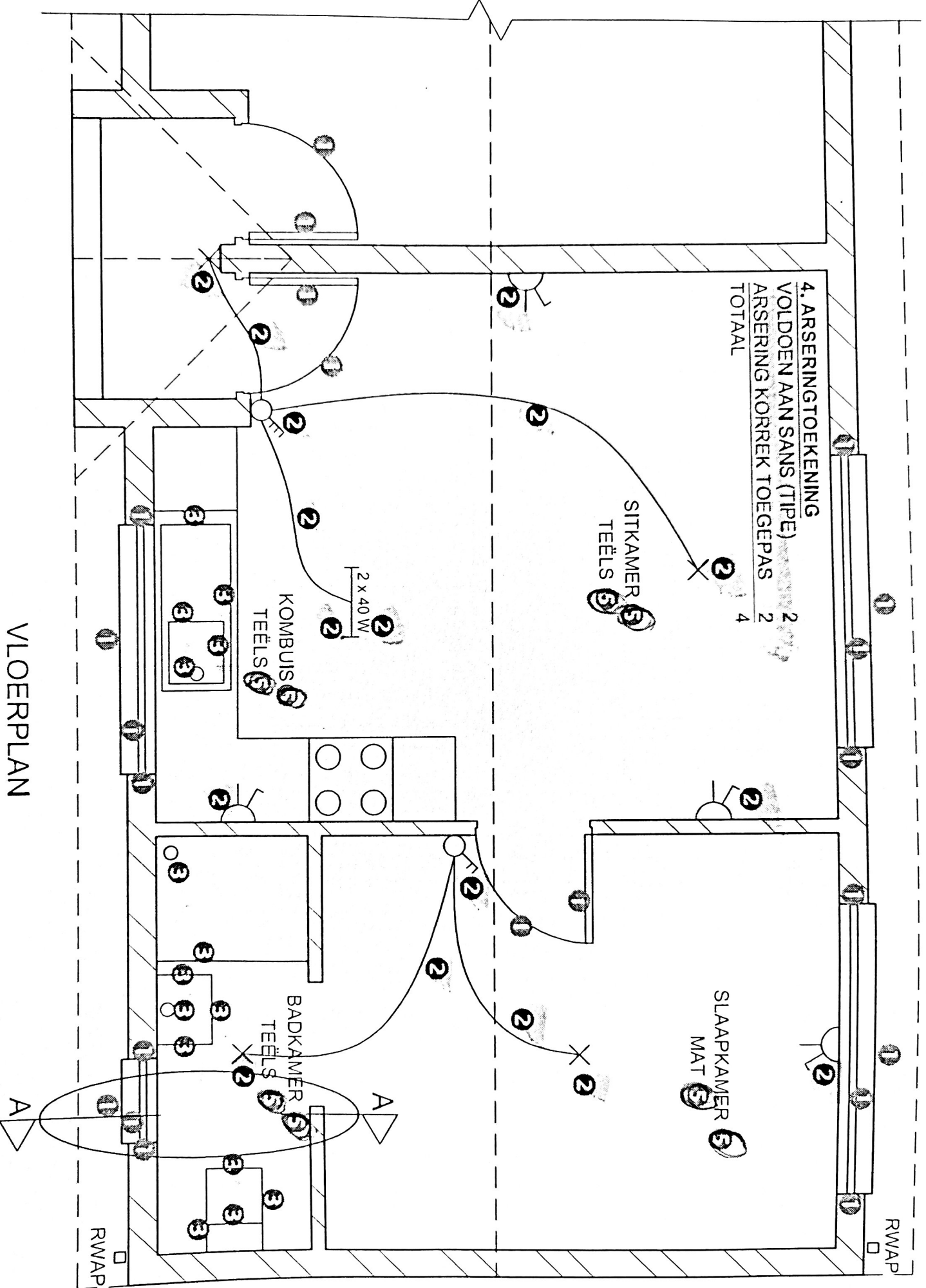

VLOERPLAN
 SKAAL 1 : 50